

Thermotherapy mass heating devices

type: F-40, F-40/B, C-14, B-85L, B-130L, B-200L



F - 40



B - 200L



F-40/B

C-14



B-130L Packing dimensions: **120 x 110 x 150** cm Weight: **+40** kg



C-14 Packing dimensions: **80 x 80 x 98** cm Weight: **+15** kg



F-40, F-40/B Packing dimensions: **80 x 80 x 96** cm Weight: **+15** kg

Thermotherapy mass heating devices:

- **Type: F-40 – Mixing device** (for automatic heating, periodic stirring (preventing its constituents from separation) and maintaining a set temperature of semi-liquid fangoparaffin or paraffin udused for heat therapy)
- **Type: F-40/B – Mixing device** (for automatic heating, periodic stirring (which allows to maintain the appropriate consistency of the mud mass) and maintaining the appropriate consistency of the mud mass at the set temperature)
- **Type: Mixer type B-85L / B-130L / B-200L** - devices for automatic heating, periodic stirring (which allows to maintain the appropriate consistency of the mud mass) and maintaining the appropriate consistency of the mud mass at the set temperature
- **Type: C-14 – Heating device** (for heating and keeping the mass at a specified temperature range)

Features F-40, F-40/B, B-85L, B-130L, B-200L:

- Used materials are resistant to corrosion (stainless steel)
- Equipped with an automatic mixing arm, which is started every few minutes for even maintenance of temperature and suitable consistency of the mass in the container
- Construction of the tank in a heat-insulating coating reduces electricity consumption (F-40, F-40/B)
- Pouring the mass from the tank through a special valve, without a need for using a scoop
- Microprocessor-controlled electronics
- Consists of a tank with a cover
- Drain valve of the tank is heated, which prevents the mass from congealing (F-40)
- The mixing arm drive is stopped automatically when the cover is lifted
- Adjustment of temperature
- Portable control panel
- Oil jacket (B-85L, B-130L and B-200L) - very low energy consumption
- Permanently connected to the power supply
- Wheels with a lock, which enable to move and lock the device in the right work place (B-85L, B-130L, B-200L)



Portable control panel C-14



Portable control panel

The electronic control panel enables programming of the following functions:

- **Heating (F-40, F-40/B, B-85L, B-130L, B-200L):** operation in range of temperature
- **Mixing (F-40, F-40/B, B-85L, B-130L, B-200):** forced continuous mixing
- **Sterilization (F-40)**
- **Timer (start in) (F-40, F-40/B, B-85L, B-130L, B-200L, C-14):** delayed start after a programmed number of hours
- **Non-stop (C-14):** constant operation to maintain the set temperature
- **Cycle (C-14):** time of the heating cycle (on/off) repeated daily

Features C-14:

- For storing mass on trays placed inside the heating unit
- Heater with a fan keeps the present temperature
- Microprocessor-controlled electronics and portable control panel
- Used materials are resistant to corrosion (stainless steel)

Technical data:

	F-40 (for fangoparaffin)	F-40/B (for paraffin)	B-85L	B-130L	B-200L	C-14	
Temperature range [°C]	55-80	55-80	30-60	30-60	30-60	25-80	
Working volume of container [l]:	40	40	40	85	130	200 14 trays (40 x 60 x 2 cm)	
Sterilization temperature [°C]:	130	110	-	-	-	-	
Power supply [V/Hz]:	400 3N/50	400 3N/50	400 3N/50	400 3N/50	400 3N/50	230/50/60	
Dimension (L x W x H) [cm]:	66 x 64 x 74	66 x 64 x 74	66 x 64 x 74	97 x 76 x 118	109 x 86 x 132	120 x 97 x 132	76 x 70 x 80
Weight [kg]:	90	90	90	300 (with oil inside)	360 (with oil inside)	380 (with oil inside)	100



MD

Guinevere



ECONOMY



PREMIUM Guinevere

Bathaid (basic equipment):

- Ergonomic design
- Specially profiled basin with arm supports
- Automatic siphon
- Electric lifting and lowering of the bathtub basin with adjustment in the range of 40 cm
- Lifting and lowering the basin by the means of a fixed panel and a remote control (with access authorization), which allows the basin to be lifted and lowered with two different lifting/lowering speeds
- Built-in bathtub disinfection system
- Shower head for washing the patient
- Handles
- Headrest
- Leg support

Technical data:

Dimensions (L x W) [mm]:	1990 x 800
Height min./max (basin edge) [mm]:	720-1120
Basin depth [mm]:	430
Drain Ø [mm]:	50
Capacity up to overflow [l]:	270
Power supply [V, Hz]:	230, 50
Device weight (ECONOMY/PREMIUM) [kg]:	210/230
Max. patient weight [kg]:	185
Max. safe working load of the bathtub (SWL) [kg]:	400
Max. filling time up to overflow (ECONOMY/ PREMIUM) (at flow ~70l/min) [min]:	~16/~9,5
Max. drainage time of the bathtub basin [min]:	~4
Lifting/lowering time (at SWL 400 kg) [s]:	29/23

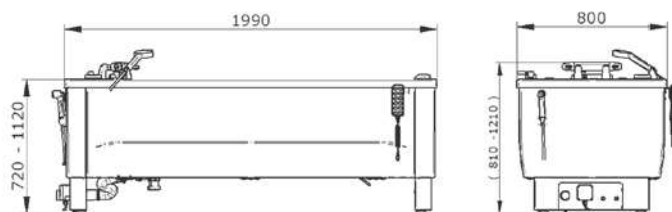

The care bathtub **Bathaid** is a modern, advanced design tub, specially created and intended for bathing and washing patients in hospitals and nursing homes, as well as in long-term care facilities. The built-in height adjustment mechanism makes it easier for the personnel to perform hygienic activities related to the daily care of the patient.

Indications:

The Bathaid bathtub helps personnel to bathe a patient with reduced mobility due to injury, illness or disability.

2 types of the Bathaid:

ECONOMY ohne Füllstopp

Additional equipment:

- Bathtub spout with thermostat
- Electronic basin water temperature indicator

Optional equipment:

- AUDIO

PREMIUM Guinevere

Additional equipment:

- Touch control panel with colour display
- Thermostatic tub faucet with an independent spout
- Automatic filling of the bathtub basin (one treatment level)
- Electronic indicator of the water temperature in basin and spout

Optional equipment:

- AUDIO
- CHROMO - 12 LED points with selecting of lighting effects

Guinevere und Avalon



If the patient cannot enter the bathtub on their own, a mobile bathtub lift, for example, should be used.



Hydraid (as seat)

MD

Avalon



Hydraid (as lying)

Features:

- Raising/lowering
- Mobile
- Equipped with a control panel and a manual remote control for height adjustment
- 3 - piece lying (+ pillow)
- Adjustment of the lying sections

Technical data:

Dimensions (as seat)	
(L x W x H (min./max.)) [mm]:	970 x 760 x 1240/1840
Dimensions (as lying)	
(L x W x H (min./max.)) [mm]:	970 x 1840 x 1240/1840
Dimensions of lying top (L x W) [mm]:	430 x 1840
Seat width [mm]:	435
Height of grip [mm]:	1190
Turn diameter [mm]:	1150
Wheels diameter (with/without brake) [mm]:	125/100
Input voltage [V, Hz]:	100-240, 50-60
Battery capacity [Ah]:	2.9
Device weight [kg]:	95
Max. safe working load (SWL) [kg]:	160
Lifting speed (raising/lowering) [s]:	42/35

The bathtub hoist **Hydraid**, with height adjustment, is designed for use in hospitals, sanatoriums and nursing homes. It is used for lifting, transferring and bathing persons with reduced mobility due to illness or dysfunction. It allows the caregiver to transfer them from the bed directly to the bathtub and back again. It can be operated by one person, which allows for ergonomic work of the personnel.

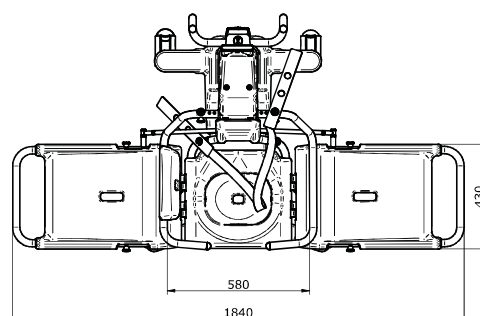
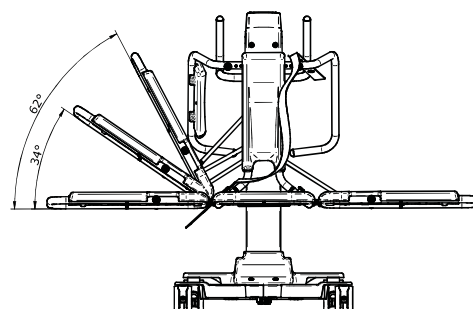
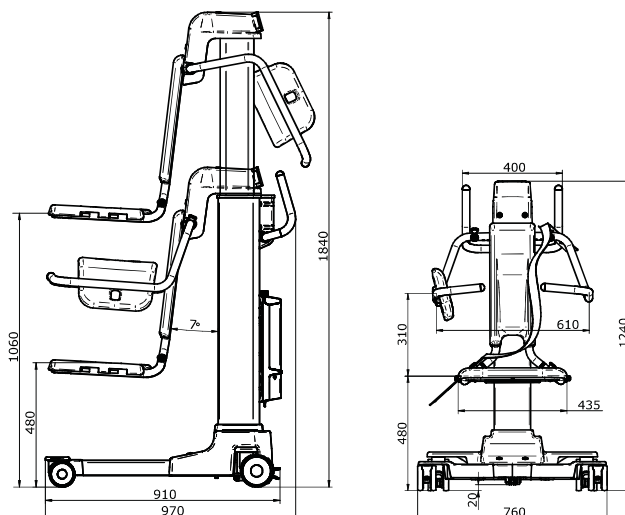

Guinevere und Avalon

The Hydraid can be used together with the care bathtub Bathaid.



MoHiCan II, MoHiCan II PLUS, MoHiCan II JUNIOR

Commode/shower chair



MoHiCan II PLUS



Camelot

The commode/shower chair MoHiCan II, MoHiCan II PLUS, MoHiCan II JUNIOR is intended for assistance during moving or performing daily routine activities of persons with physical impairment disabilities. The chair allows the personnel to adjust both, height and tilt of the seat enabling the patient to remain in the fixed position for a long time. For use in private homes, hospitals, sanatoriums, nursing homes or any other care facilities.

Applications:

It finds a wide range of applications in assisting personnel in caring for patients with conditions such as: cerebral apoplexy; pressures ulcers; mobility disability; Parkinson disease; cephalically-cerebral injury; chronic immobilization; musculoskeletal disorders; disability; paralysis.

Features:

- Battery operated
- Made of welded powder-coated stainless steel sections
- Hand control with functions: raising/lowering seat, forward/backward tilt (seat)
- Actuators: main actuator (on both sides) for raising/lowering seat; actuator for tilting
- Footboard with height adjustment and a foldable base
- 4 castors with a brake
- Removable seat with a plug and with a toilet bowl



Removable battery
easy to recharge



Hand control

Additional accessories:

- torso belt (for patient stabilization)
- leg belt (for legs stabilization)



Armrests

can be lifted for easy access to the patient



Movable

castors whit brake



Easy removable

toilet bowl



Head support

adjustable for max. comfort of patient

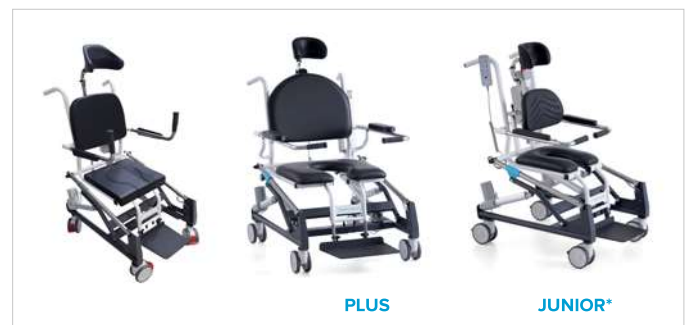

PLUS

JUNIOR*

Technical Data:

Type	Camelot		
	MoHiCan II	MoHiCan II JUNIOR*	MoHiCan II PLUS
Length [mm]:	870	935	940
Width [mm]:	670	656	770
Height of the push bar (min./max) [mm]:	1022/1315	1060/1280	1060/1280
Raising height range [mm]:	476-1005	500-1030	500-1050
Tilt adjustment [°]:		-5/+26	
Height of legrest (from floor) [mm]:		112	
Turning diameter [mm]:	1100	1100	1200
Lifting speed LINAK (raising) (0/max load) [sec] :		42/49	
Lifting speed LINAK (lowering) (0/max load) [sec] :		47/41	
Diameter of castors with brake [mm]:		125	
Power supply [V, HZ]:		100-240*, 50/60	
Battery capacitance [Ah]:		2,9	
Protection level of the control panel, acutators and hand control:		IPX6	
Max load (SWL) [kg]	180	120	250
Mass [kg]:	60	50	70
Maximum noise level (dB):		52	

*-MoHiCan II JUNIOR buying possibility - ask question

